

**技术规范 Technique norm**

设计依据 Design Basis	GB标准 Standard		
设计标准 Design standard	GB/12237		
结构长度 Face to face dimension	法兰 连接 Flange Connecting	HKQB标准 Standard of HKQB	
连接法兰尺寸 Connecting Flange Size	GB/9113JB/T79		
试验和检验 Test & inspection	JB/T9092		

※注：系列球阀结构长度及连接法兰尺寸可根据用户要求设计制造。  
Note: The structural length and connecting flange size of ball valve series can be designed and manufactured as per users' requirements.

**主要零件材质表 Form of Main Parts Materials**

序号 No.	零件名称 Name of parts	材质 Material		
		C	P	R
1	阀盖 Bonnet	WCB	ZG1Cr18Ni9Ti	ZG1Cr18Ni12Mo2Ti
2	垫片 Gasket	PTFE、对位聚苯(PPL)		
3	阀座 Seat	PTFE、尼龙(Nylon)、对位聚苯(PPL)		
4	球体 Ball	1Cr18Ni9Ti	1Cr18Ni9Ti	1Cr18Ni9Ti
5	阀座 Seat	PTFE、尼龙(Nylon)、对位聚苯(PPL)		
6	阀体 Body	WCB	ZG1Cr18Ni9Ti	ZG1Cr18Ni12Mo2Ti
7	螺栓 Sutd	35	1Cr18Ni9Ti	1Cr1812Mo2Ti
8	阀杆 Stem	1Cr13	1Cr18Ni9Ti	1Cr1812Mo2Ti
9	垫片 Gasket	1Cr18Ni9Ti	1Cr18Ni9Ti	1Cr1812Mo2Ti
10	填料 Packing	PTFE	PTFE	PTFE
11	衬套 Bushing	PTFE复合轴承 Composite bearings		
12	弹垫 Spring Gasket	WCB	ZG1Cr18Ni9Ti	ZG1Cr18Ni12Mo2Ti
13	垫片 Gasket	35	1Cr18Ni9Ti	1Cr18Ni9Ti
14	螺母 Nut	35	1Cr18Ni9Ti	1Cr18Ni9Ti
15	连接支架 Connecting Yoke	1Cr18Ni9Ti	1Cr18Ni9Ti	1Cr18Ni9Ti
16	螺栓 Screw	35	1Cr18Ni9Ti	1Cr18Ni9Ti
17	连接套 Connecting Set	35	1Cr18Ni9Ti	1Cr18Ni9Ti
18	气动装置 Pneumatic Device	AT系列、AT Series		
19	位置指示器 Location Indicator	塑料 Plastic		

※注：系列球阀主要零部件及密封圈的材质可根据实际工况条件或用户特殊要求设计选用。  
Note: The main spare parts and sealing-ring materials of ball valve series can be designed for options as per real working conditions and users'special requirements.

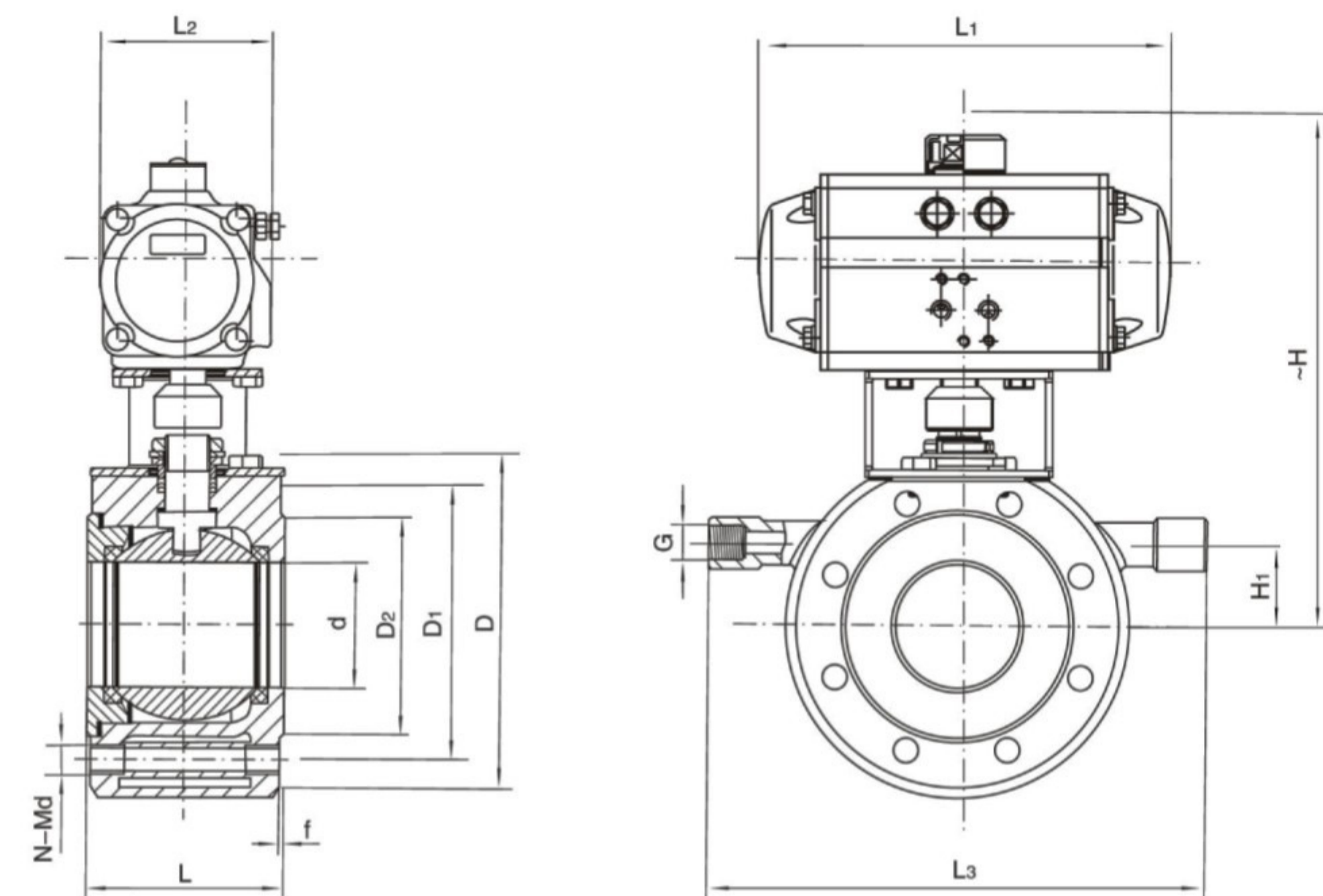

**主要外形及连接尺寸 VP11-THI-PN16(1.6Mpa) Main Outline and Connecting Flange Size**

公称通径 Nominal diameter DN	外形尺寸 Outline Size						连接法兰尺寸 Connecting Flange Size						执行器型号 Actuator Model
	d	L	L1	L2	~H	H1	D	D1	D2	f	G	N-Md	
15	15	32	141/159	71/83	177/208	15	95	65	46	2	1/2"	4-M12	AT050D/AT063S
20	20	38.5	141/159	71/83	182/213	20	105	75	56	2	1/2"	4-M12	AT050D/AT063S
25	25	45	141/211	71/95	187/230	20	115	85	65	2	1/2"	4-M12	AT050D/AT075S
32	29	55	159/211	83/95	223/243	25	140	100	76	3	1/2"	4-M16	AT063D/AT075S
40	38	62	211/248	95/107	231/261	30	150	110	84	3	1/2"	4-M16	AT075D/AT088S
50	46	72	248/269	107/123	258/293	30	165	125	99	3	1/2"	4-M16	AT075D/AT100S
65	62	95	248/315	107/141	273/298	45	185	145	118	3	1/2"	4-M16	AT088D/AT115S
80	76	120	269/345	123/152	303/325	50	200	160	132	3	1/2"	8-M16	AT100D/AT125S
100	92	145	345/409	152/172	333/390	70	220	180	156	3	1"	8-M16	AT125D/AT145S
125	110	200	409/438	172/187	380/468	80	250	210	184	3	1"	8-M16	AT145D/AT160S
150	145	225	438/550	187/215	432/520	95	285	240	211	3	1"	8-M20	AT160D/AT190S

※注：连接法兰尺寸可根据ANSI、JIS标准或用户要求设计制造。  
※注：L1数据XXX/XXX分别是气动执行器双作用式/单作用式（弹簧复位）。  
※注：根据不同阀门扭矩、使用介质适配的执行器型号可能有所不同，相关尺寸随之变化。  
Note: The connecting flange size can be designed and manufactured in accordance with ANSI or JIS standard or requested by users.  
Note: Date xxx/xxx represent respectively the double-acting/single-acting type (spring reposition) of pneumatic actuator.  
Note: The relative sizes are subject to change responding to the differene in valve torque, medium and actuator model